



Method(e):

0061
30–160 mg/L NH₄-N

0062
40–200 mg/L NH₄⁺

0063
40–200 mg/L NH₃

20–80 %:

30 56 134 160 mg/L NH₄-N



40 72 168 200 mg/L NH₄⁺ / NH₃

REF 985 006

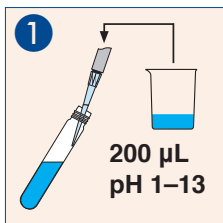

Probe / Sample
Échant. / Muestra

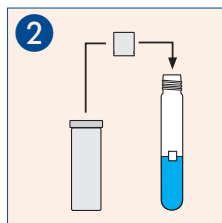

1 x **NANOFIX R2**

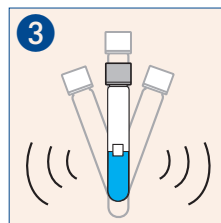

Schütteln / Shake
Agiter / Agitar

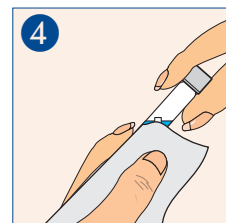

Säubern / Clean
Nettoyer / Limpiar

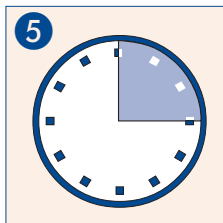

15'00 min

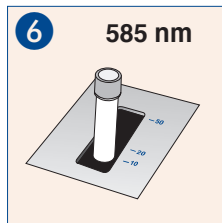

Messen / Measure
Mesurer / Medir