



Method(e):

0081

4–80 mg/L NH₄-N

0082

5–100 mg/L NH₄⁺

0083

5–100 mg/L NH₃

20–80 %:

4

19

65

80 mg/L NH₄-N

5

24

81

100 mg/L NH₄⁺ / NH₃

REF 985 008

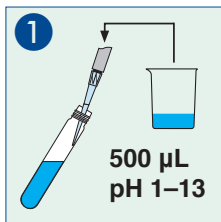

Probe / Sample
Échant. / Muestra

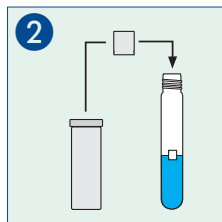

1 x **NANOFIX R2**

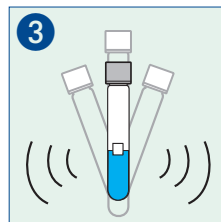

Schütteln / Shake
Agiter / Agitar

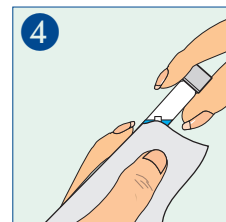

Säubern / Clean
Nettoyer / Limpiar

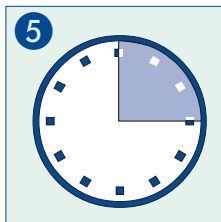

15'00 min

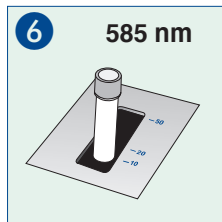

Messen / Measure
Mesurer / Medir