



Method(e):

0761	0762
0.05–1.50 mg/L P	0.2–5.0 mg/L PO <sub>4</sub> <sup>3-</sup>

20–80 %:

0.05	0.34	1.21	1.50 mg/L P
			
0.2	1.2	4.0	5.0 mg/L PO <sub>4</sub> <sup>3-</sup>

REF 985 076

1/2

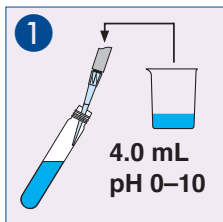

1  
4.0 mL  
pH 0–10  
Probe / Sample  
Échant. / Muestra

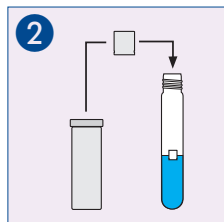

2  
1 x **NANOFIX R2**

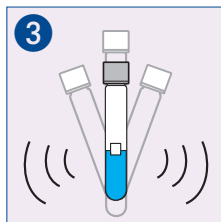

3  
Schütteln / Shake  
Agiter / Agitar

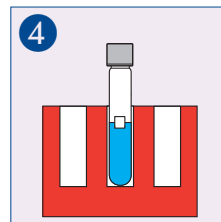

4  
120 °C / 30 min  
100 °C / 1 h

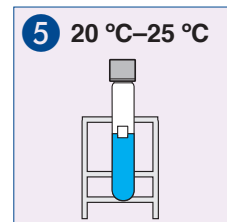

5 20 °C–25 °C  
Abkühlen / Cool  
Refróidrir / Enfriar

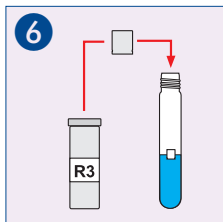

6  
1 x **NANOFIX R3**

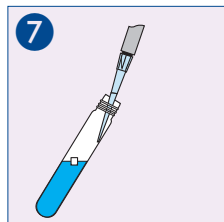

7  
200 µL R4

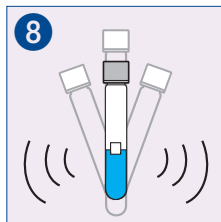

8  
Schütteln / Shake  
Agiter / Agitar

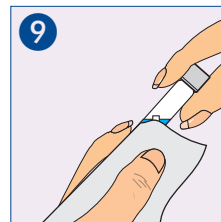

9  
Säubern / Clean  
Nettoyer / Limpiar

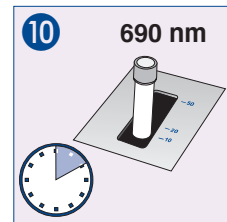

10 690 nm  
Messen / Measure  
Mesurer / Medir

A037178 / 985 076 / 03215

# NANOCOLOR® ortho-Phosphat 1 / Phosphate / Fosfato



Method(e):

0765	0766
0.05–1.50 mg/L PO <sub>4</sub> -P	0.2–5.0 mg/L PO <sub>4</sub> <sup>3-</sup>

20–80 %:

0.05	0.34	1.21	1.50 mg/L PO <sub>4</sub> -P
0.2	1.2	4.0	5.0 mg/L PO <sub>4</sub> <sup>3-</sup>



REF 985 076

2/2

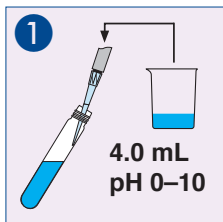

Probe / Sample  
Échant. / Muestra

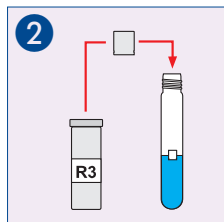

1 x **NANOFIX R3**

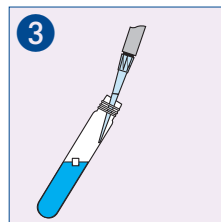

200 µL **R4**

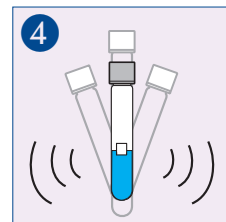

Schütteln / Shake  
Agiter / Agitar

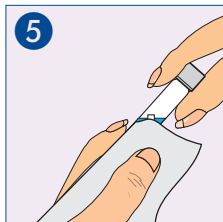

Säubern / Clean  
Nettoyer / Limpiar

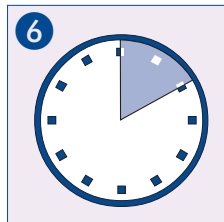

10'00 min

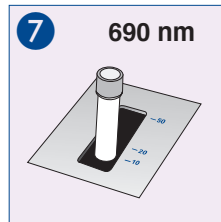

Messen / Measure  
Mesurer / Medir