



Method(e):

0041 0.2–8.0 mg/L NH ₄ -N	0042 0.2–10.0 mg/L NH ₄ ⁺	0043 0.2–10.0 mg/L NH ₃
---	--	---------------------------------------

20–80 %:

0.2	1.8	6.4	8.0 mg/L NH ₄ -N
			
0.2	2.2	8.0	10.0 mg/L NH ₄ ⁺ /NH ₃

REF 985 004

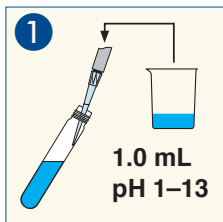

Probe / Sample
Échant. / Muestra

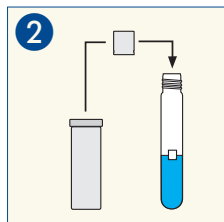

1 x **NANOFIX R2**

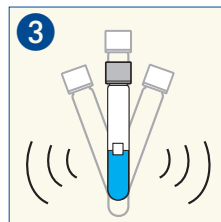

Schütteln / Shake
Agiter / Agitar

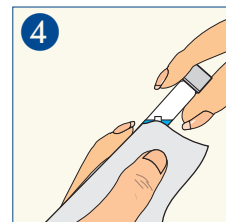

Säubern / Clean
Nettoyer / Limpiar

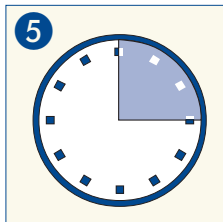

15'00 min

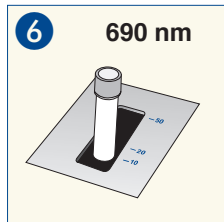

Messen / Measure
Mesurer / Medir