



Method(e):

0111

400–4000 mg/L O₂

20–80 %:

400 1120

3280 4000 mg/L O₂



REF 985 011

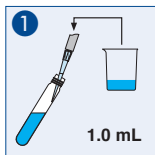

Probe / Sample
Échant. / Muestra

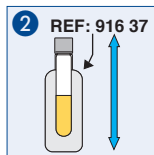

Schütteln / Shake
Agiter / Agitar

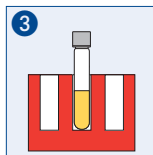

148 °C / 2 h

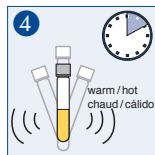

Schütteln / Shake
Agiter / Agitar

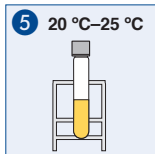

Abkühlen / Cool
Refridir / Enfriar

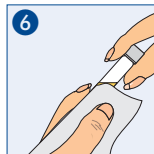

Säubern / Clean
Nettoyer / Limpiar



Messen / Measure
Mesurer / Medir